

TOKISTAR Exhibitor



TOKISTAR LIGHTING



Exhibitor Series

TOKISTAR® Exhibitor Series is a wet-location festoon lighting system widely used in amusement parks, shopping centers, street decorations and promenades. Exhibitor fixtures may also be surface mounted to accent rooflines and other architectural features.

Light sources include solid-state LEDs and incandescent xenon lamps, enclosed within shatterproof polycarbonate globes. These globes are injection blow-molded for a seamless appearance and excellent clarity. Each globe includes two o-rings for a secure and weatherproof seal to the socket.



LEDs

Tokistar LEDs operate at 24VAC and consume only 0.48 Watts. This makes them our most energy-efficient light source and dramatically increases the maximum run length of each fixture. With incredible life ratings, LEDs are ideally suited for continuous operation in commercial applications.



Xenon Lamps

For a traditional incandescent look, our wedge-base lamps create crisp pin-points of light when specified with transparent globes. These xenon-gas lamps have the apparent brightness of much higher wattage standard incandescent lamps, and significantly longer life.



LEDs shown below with frosted globes.



Lamp	Watts/Volts	Hours	Lumens	Color
EX-212	4.2 Watts / 12VAC	10,000	35	2550K
EX-124	7.5 Watts / 24VAC	10,000	65	2500K



In addition to clear and frosted globes, xenon lamps are available with green, amber, blue, red, and violet colored globes.

Specifications



All plastic components comply with UL746C in respect to Ultraviolet Light and Water Absorption testing.

Light Sources include LEDs and xenon lamps

Polycarbonate Globe with flammability rating UL 94V-0

Flexible Conductors #12 AWG stranded and plated wire

Two O-Rings on each globe for weatherproof seal

Sockets permanently fastened to cable with sealant

Insulation is flexible PVC with flammability rating UL 94 HB



EXBK - 12 - WW - F

How to Specify

Three key considerations in specifying an Exhibitor Lighting System are:

1) Socket Spacing

Consider viewing distance and perspective when deciding on socket spacing. Wider spacings (18"-24") are the best choice for most festooning applications. Closer spacings (6"-12") are appropriate for applications at closer viewing range.

2) Light Source

LEDs create a softer lighting effect and are the most energy-efficient choice. Since LEDs consume so little energy, they can run much greater distances from a single feed point. Xenon lamps will produce brighter distinct points of light.

3) Globe Selection

Clear globes have excellent clarity and will emphasize the distinct points of incandescent or LED light. Frosted globes will diffuse light on their entire surface. Colored globes in combination with xenon lamps create vibrant color.

Cable / Socket Color		Socket Spacing		LED			Globe	
Code	Color	Code	Inches (mm)	Code	Color	Watts/Volts	Code	Globe Color
BK	Black	6	6" (150 mm)	WW	Warm White	0.48 W / 24 VAC	C	Clear
WH	White	12	12" (300 mm)	WH	White	0.48 W / 24 VAC	F	Frosted
		18	18" (450 mm)	BL	Blue	0.48 W / 24 VAC	G	Green
		24	24" (600 mm)	GR	Green	0.48 W / 24 VAC	A	Amber
			(Custom Spacing is Available)	OR	Orange	0.48 W / 24 VAC	B	Blue
				PL	Purple	0.48 W / 24 VAC	R	Red
				RD	Red	0.48 W / 24 VAC	V	Violet
				YG	Yellow-Green	0.48 W / 24 VAC	M	Multi-Colors
				(Any Combination of Colors is Possible)				
Xenon Lamp								
		212		2550K		4.2 W / 12VAC		
		124		2500K		7.5 W / 24VAC		

Mounting Options

Exhibitor Series can be surface mounted to structures using our mounting disks or straps. For festoon applications, our wire rope adaptor securely holds each socket in place to 1/16" or 1/8" ø wire rope.

Surface Mounting using Disks

Part# EX-MD-WH (White)
Part# EX-MD-BK (Black)

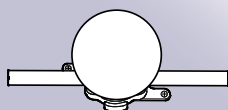
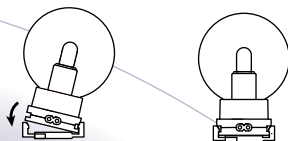
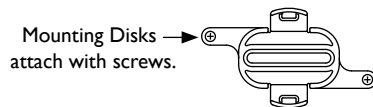

Surface Mounting using Straps

Part# EX-MS-WH (White)
Part# EX-MS-BK (Black)

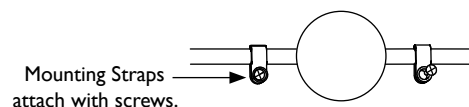

Festoon Applications w/Wire Rope Adaptors

Part# EX-MDA-WH (White)
Part# EX-MDA-BK (Black)

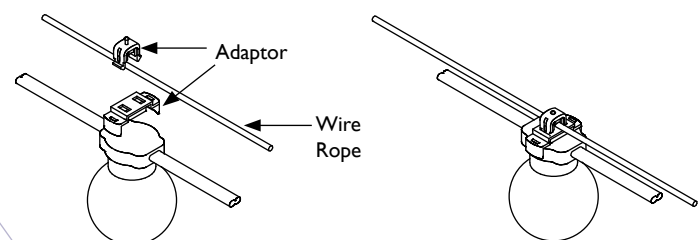

Sizes and Lengths

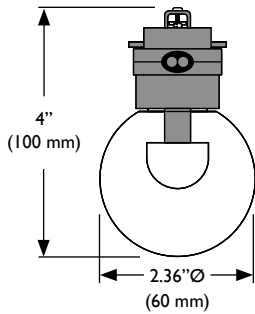

To minimize voltage drop and keep conductors safely within their ratings, do not exceed the maximum lengths shown for each independent fixture.

Socket Spacing	Maximum Run Lengths		
	LED	Xenon Lamps	
	.48 Watt / 24VAC	4.2 Watt / 12VAC	7.5 Watt / 24VAC
6" (150 mm)	250' (76 M)	24' (7 M)	32' (10 M)
12" (300 mm)	350' (106 M)	36' (11 M)	56' (17 M)
18" (450 mm)	426' (130 M)	45' (14 M)	72' (22 M)
24" (600 mm)	492' (150 M)	50' (15 M)	80' (24 M)

Transformers

Tokistar transformers operate from a 120 VAC/60 Hz input and are fully dimmable. They are provided in a Nema 3R enclosure suitable for wet locations. The secondary outputs are protected by circuit breakers.

Transformers should be installed in an accessible location. Magnetic transformers generate heat and must be installed in locations where there is free air circulation.

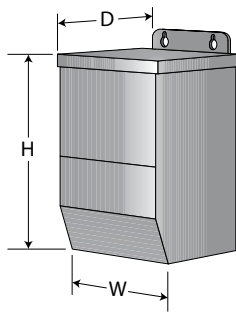

T12 Series Transformers					
Number	Outputs	D	H	W	Weight
T12-100	1 @ 100 Watt / 12 VAC	3.0"	9.0"	3.0"	5 lbs
T12-150	1 @ 150 Watt / 12 VAC	3.0"	9.0"	3.0"	5 lbs
T12-250	1 @ 250 Watt / 12 VAC	3.5"	9.5"	4.5"	8 lbs
T12-300	1 @ 300 Watt / 12 VAC	3.5"	9.5"	4.5"	8 lbs
T12-500	2 @ 250 Watt / 12 VAC	4.5"	10.5"	4.5"	12 lbs
T12-600	2 @ 300 Watt / 12 VAC	4.5"	10.5"	4.5"	15 lbs
T12-750	3 @ 250 Watt / 12 VAC	4.5"	10.5"	4.5"	15 lbs
T12-1000	4 @ 250 Watt / 12 VAC	5.0"	11.5"	7.0"	28 lbs
T12-1200	4 @ 300 Watt / 12 VAC	5.0"	11.5"	7.0"	28 lbs

T24 Series Transformers					
Number	Outputs	D	H	W	Weight
T24-100	1 @ 100 Watt / 24 VAC	3.0"	9.0"	3.0"	5 lbs
T24-150	1 @ 150 Watt / 24 VAC	3.0"	9.0"	3.0"	5 lbs
T24-250	1 @ 250 Watt / 24 VAC	3.5"	9.5"	4.5"	8 lbs
T24-300	1 @ 300 Watt / 24 VAC	3.5"	9.5"	4.5"	8 lbs
T24-500	1 @ 500 Watt / 24 VAC	4.5"	10.5"	4.5"	12 lbs
T24-600	1 @ 600 Watt / 24 VAC	4.5"	10.5"	4.5"	15 lbs
T24-750	2 @ 375 Watt / 24 VAC	4.5"	10.5"	4.5"	15 lbs
T24-1000	2 @ 500 Watt / 24 VAC	5.0"	11.5"	7.0"	28 lbs
T24-1200	2 @ 600 Watt / 24 VAC	5.0"	11.5"	7.0"	28 lbs

Consult factory for transformers with input voltages of 230 or 277 VAC. Sizes and weights shown are approximate and subject to change without notice.

The recommended maximum distance between the fixture and the transformer varies based on the load of each fixture and the size of secondary wire feeding the fixture. Electrical engineers and contractors can calculate these distances.

Should you need guidance, consult the factory.

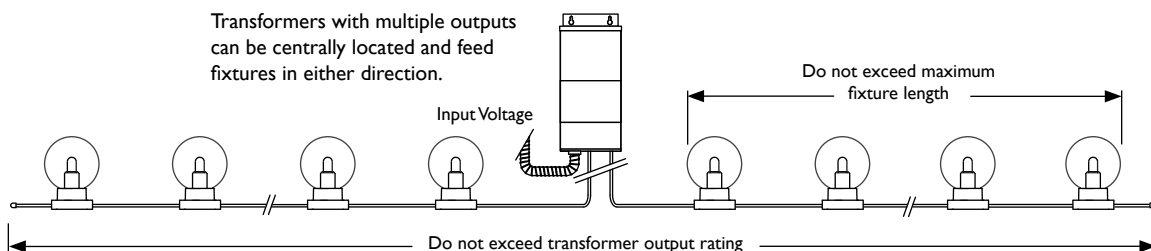

TOKISTAR® LIGHTING INC.

1015 E. Discovery Lane • Anaheim, CA 92801

Tel: 714.772.7005 • Fax: 714.772.7014 • Toll free in U.S.A.: 877.340.7633

E-mail: info@tokistar.com • Web site: www.tokistar.com